

UCFCX (Medium-duty)

Flange Cartridge Units

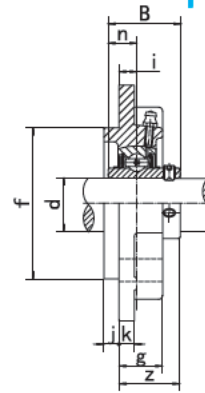
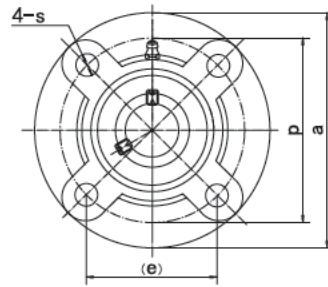

| Unit NO. | Dimensions (mm / in.) | | | | | | | | | | | | | Bolt Size mm/in. | Bearing No. | Housing No. | Weight (kg) |
|--|--|---------------|----------------|------------------|-------------|-------------|-------------|------------|---------------|---------------|-----------------|----------------|---------------|---------------------|---|----------------|----------------|
| | d | a | p | (e) | i | s | j | k | g | f | z | B | n | | | | |
| UCFCX05 X05-13 X05-14 X05-15 X05-16 | 25 13/16 7/8 15/16 1 | 111 4-3/8 | 92 3-5/8 | 65 2-9/16 | 10 25/64 | 9.5 3/8 | 6 15/64 | 9.5 3/8 | 24 15/16 | 76 2.9921 | 32.2 1-9/32 | 38.1 1.5000 | 15.9 0.626 | M8 5/16 | UCX05 UCX05-13 UCX05-14 UCX05-15 UCX05-16 | FCX05 | 1.10 |
| UCFCX06 X06-17 X06-18 X06-19 X06-20 | 30 1-1/16 1-1/8 1-3/16 1-1/4 | 127 5 | 105 4-9/64 | 74.2 2-59/64 | 8 5/16 | 12 15/32 | 9.5 3/8 | 9.5 3/8 | 22.5 7/8 | 85 3.3465 | 33.4 1-5/16 | 42.9 1.6890 | 17.5 0.689 | M10 3/8 | UCX06 UCX06-17 UCX06-18 UCX06-19 UCX06-20 | FCX06 | 1.40 |
| UCFCX07 X07-21 X07-22 X07-23 | 35 1-5/16 1-3/8 1-7/16 | 133 5-1/4 | 111 4-3/8 | 78.5 3-3/32 | 9 23/64 | 12 15/32 | 11 7/16 | 11 7/16 | 26 1-1/32 | 92 3.6220 | 39.2 1-17/32 | 49.2 1.9370 | 19 0.748 | M10 3/8 | UCX07 UCX07-21 UCX07-22 UCX07-23 | FCX07 | 1.80 |
| UCFCX08 X08-24 X08-25 | 40 1-1/2 1-9/16 | 133 5-1/4 | 111 4-3/8 | 78.5 3-3/32 | 9 23/64 | 12 15/32 | 11 7/16 | 11 7/16 | 26 1-1/32 | 92 3.6220 | 39.2 1-17/32 | 49.2 1.9370 | 19 0.748 | M14 3/8 | UCX08 UCX08-24 UCX08-25 | FCX08 | 1.80 |
| UCFCX09 X09-26 X09-27 X09-28 X09-29 | 45 1-5/8 1-11/16 1-3/4 1-13/16 | 155 6-3/32 | 130 5-1/8 | 91.9 3-5/8 | 8 5/16 | 14 35/64 | 12 15/32 | 11 7/16 | 25 63/64 | 108 4.2520 | 40.6 1-19/32 | 51.6 2.0315 | 19 0.748 | M12 7/16 | UCX09 UCX09-26 UCX09-27 UCX09-28 UCX09-29 | FCX09 | 2.40 |
| UCFCX10 X10-30 X10-31 X10-32 | 50 1-7/8 1-15/16 2 | 162 6-3/8 | 136 5-23/64 | 96.2 3-25/32 | 7 9/32 | 14 35/64 | 16 5/8 | 11 7/16 | 25 63/64 | 118 4.6457 | 40.4 1-19/32 | 55.6 2.1890 | 22.2 0.874 | M12 7/16 | UCX10 UCX10-30 UCX10-31 UCX10-32 | FCX10 | 2.90 |
| UCFCX11 X11-33 X11-34 X11-35 X11-36 X11-37 | 55 2-1/16 2-1/8 2-3/16 2-1/4 2-5/16 | 180 7-3/32 | 152 5-63/64 | 107.5 4-15/64 | 4 5/32 | 16 5/8 | 22 55/64 | 13 1/2 | 26 1-1/32 | 127 5.0000 | 43.7 1-23/32 | 65.1 2.5630 | 25.4 1 | M14 1/2 | UCX11 UCX11-33 UCX11-34 UCX11-35 UCX11-36 UCX11-37 | FCX11 | 3.80 |
| UCFCX12 X13-38 X13-39 | 60 2-3/8 2-7/16 | 194 7-5/8 | 165 6-1/2 | 116.7 4-19/32 | 11 7/16 | 16 5/8 | 20 25/32 | 14 9/16 | 33 1-5/16 | 140 5.5118 | 50.7 2 | 65.1 2.5630 | 25.4 1 | M14 1/2 | UCX12 UCX12-38 UCX12-39 | FCX12 | 4.90 |
| UCFCX13 X13-40 X13-41 | 65 2-1/2 2-9/16 | 194 7-5/8 | 165 6-1/2 | 116.7 4-19/32 | 11 7/16 | 16 5/8 | 20 25/32 | 14 9/16 | 33 1-5/16 | 140 5.5118 | 55.4 2-3/16 | 74.6 2.9370 | 30.2 1.189 | M14 1/2 | UCX13 UCX13-40 UCX13-41 | FCX13 | 4.90 |
| UCFC14 X14-42 X14-43 X14-44 | 70 2-5/8 2-11/16 2-3/4 | 222 8-3/4 | 190 7-31/64 | 134.3 5-9/32 | 14 35/64 | 19 3/4 | 20 25/32 | 14 9/16 | 36 1-13/32 | 164 6.4567 | 58.5 2-5/16 | 77.8 3.0630 | 33.3 1.311 | M16 5/8 | UCX14 UCX14-42 UCX14-43 UCX14-44 | FCX14 | 6.60 |
| UCFCX15 X15-45 X15-46 X15-47 X15-48 | 75 2-13/16 2-7/8 2-15/16 3 | 222 8-3/4 | 190 7-31/64 | 134.3 5-9/32 | 12 15/32 | 19 3/4 | 22 55/64 | 16 5/8 | 35 1-3/8 | 164 6.4567 | 61.3 2-13/32 | 82.6 3.2520 | 33.3 1.311 | M16 5/8 | UCX15 UCX15-45 UCX15-46 UCX15-47 UCX15-48 | FCX15 | 7.20 |
| UCFCX16 X16-49 X16-50 X16-51 X16-52 | 80 3-1/16 3-1/8 3-3/16 3-1/4 | 260 10-1/4 | 219 8-5/8 | 154.8 6-3/32 | 10 25/64 | 23 29/32 | 25 63/64 | 19 3/4 | 36 1-13/32 | 186 7.3228 | 61.6 2-7/16 | 85.7 3.3740 | 34.1 1.343 | M20 3/4 | UCX16 UCX16-49 UCX16-50 UCX16-51 UCX16-52 | FCX16 | 10.00 |
| UCFCX17 X17-53 X17-55 | 85 3-5/16 3-7/16 | 260 10-1/4 | 219 8-5/8 | 154.8 6-3/32 | 10 25/64 | 23 29/32 | 25 63/64 | 19 3/4 | 36 1-13/32 | 186 7.3228 | 66.3 2-5/8 | 96 3.7795 | 39.7 1.563 | M20 3/4 | UCX17 UCX17-53 UCX17-55 | FCX17 | 11.40 |