

Flange Cartridge Units

UCFC2 (Normal-duty)

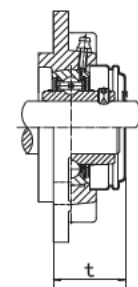
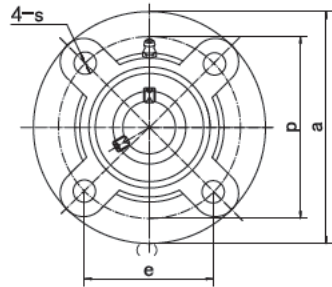
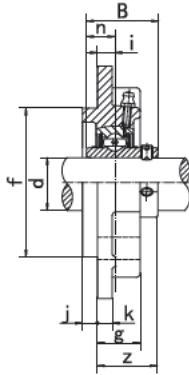

UCFC-C1(D1)

Unit NO.	Dimensions (mm / in.)														Bolt Size mm/in.	Bearing No.	Housing No.	Weight (kg)
	d	a	p	(e)	i	s	j	k	g	f	z	t	B	n				
UCFC201 201-8	12 1/2	100 3-15/16	78 3-5/64	55.1 2-11/64	10 25/64	12 15/32	5 13/64	7 9/32	20.5 13/16	62 2.4409	28.3 1-1/8	32.5 1-9/32	31.0 1.2205	12.7 0.500	M10 3/8	UC201 UC201-8	FC201	0.70 0.69
UCFC202 202-9 202-10	15 9/16 5/8	100 3-15/16	78 3-5/64	55.1 2-11/64	10 25/64	12 15/32	5 13/64	7 9/32	20.5 13/16	62 2.4409	28.3 1-1/8	32.5 1-9/32	31.0 1.2205	12.7 0.500	M10 3/8	UC202 UC202-9 UC202-10	FC202	0.69 0.69 0.69
UCFC203 203-11	17 11/16	100 3-15/16	78 3-5/64	55.1 2-11/64	10 25/64	12 15/32	5 13/64	7 9/32	20.5 13/16	62 2.4409	28.3 1-1/8	32.5 1-9/32	31.0 1.2205	12.7 0.500	M10 3/8	UC203 UC203-11	FC203	0.68 0.67
UCFC204 204-12	20 3/4	100 3-15/16	78 3-5/64	55.1 2-11/64	10 25/64	12 15/32	5 13/64	7 9/32	20.5 13/16	62 2.4409	28.3 1-1/8	32.5 1-9/32	31.0 1.2205	12.7 0.500	M10 3/8	UC204 UC204-12	FC204	0.66 0.66
UCFC205 205-13 205-14 205-15 205-16	25 13/16 7/8 15/16 1	115 4-17/32	90 3-35/64	63.6 2-1/2	10 25/64	12 15/32	6 15/64	7 9/32	21 53/64	70 2.7559	29.8 1-11/64	34.0 1-11/32	34.1 1.3425	14.3 0.563	M10 3/8	UC205 UC205-13 UC205-14 UC205-15 UC205-16	FC205	0.89 0.92 0.91 0.89 0.88
UCFC206 206-17 206-18 206-19 206-20	30 1-1/16 1-1/8 1-3/16 1-1/4	125 4-59/64	100 3-15/16	70.7 2-25/32	10 25/64	12 15/32	8 5/16	8 5/16	23 29/32	80 3.1496	32.2 1-17/64	36.5 1-7/16	38.1 1.5000	15.9 0.626	M10 3/8	UC206 UC206-17 UC206-18 UC206-19 UC206-20	FC206	1.18 1.19 1.20 1.18 1.17
UCFC207 207-20 207-21 207-22 207-23	35 1-1/4 1-5/16 1-3/8 1-7/16	135 5-5/16	110 4-21/64	77.8 3-1/16	11 7/16	14 35/64	8 5/16	9 23/64	26 1-1/32	90 3.5433	36.4 1-7/16	41.0 1-5/8	42.9 1.6890	17.5 0.689	M12 7/16	UC207 UC207-20 UC207-21 UC207-22 UC207-23	FC207	1.53 1.59 1.56 1.53 1.50
UCFC208 208-24 208-25	40 1-1/2 1-9/16	145 5-45/64	120 4-23/32	84.8 3-11/32	11 7/16	14 35/64	10 25/64	9 23/64	26 1-1/32	100 3.9370	41.2 1-5/8	45.5 1-51/64	49.2 1.9370	19.0 0.748	M12 7/16	UC208 UC208-24 UC208-25	FC208	1.85 1.89 1.86
UCFC209 209-26 209-27 209-28	45 1-5/8 1-11/16 1-3/4	160 6-19/64	132 5-13/64	93.3 3-43/64	10 25/64	16 5/8	12 15/32	14 35/64	26 1-1/32	105 4.1339	40.2 1-37/64	44.5 1-3/4	49.2 1.9370	19.0 0.748	M14 1/2	UC209 UC209-26 UC209-27 UC209-28	FC209	2.53 2.63 2.59 2.55
UCFC210 210-29 210-30 210-31 210-32	50 1-13/16 1-7/8 1-15/16 2	165 6-1/2	138 5-7/16	97.6 3-27/32	10 25/64	16 5/8	12 15/32	14 35/64	28 1-7/64	110 4.3307	42.6 1-11/16	47.5 1-7/8	51.6 2.0315	19.0 0.748	M14 1/2	UC210 UC210-29 UC210-30 UC210-31 UC210-32	FC210	2.78 2.90 2.85 2.80 2.76
UCFC211 211-32 211-33 211-34 211-35	55 2 2-1/16 2-1/8 2-3/16	185 7-9/32	150 5-29/32	106.1 4-3/16	13 33/64	19 3/4	12 15/32	15 19/32	31 1-7/32	125 4.9213	46.4 1-53/64	51.0 2-1/64	55.6 2.1890	22.2 0.874	M16 5/8	UC211 UC211-32 UC211-33 UC211-34 UC211-35	FC211	3.86 4.01 3.95 3.91 3.84
UCFC212 212-36 212-37 212-38 212-39	60 2-1/4 2-5/16 2-3/8 2-7/16	195 7-11/16	160 6-19/64	113.1 4-29/64	17 43/64	19 3/4	12 15/32	15 19/32	36 1-27/64	135 5.3150	56.7 2-15/64	61.5 2-27/64	65.1 2.5630	25.4 1.000	M16 5/8	UC212 UC212-36 UC212-37 UC212-38 UC212-39	FC212	4.69 4.82 4.74 4.67 4.60
UCFC213 213-40 213-41	65 2-1/2 2-9/16	205 8-5/64	170 6-11/16	120.2 4-47/64	16 5/8	19 3/4	14 35/64	15 19/32	36 1-27/64	145 5.5118	55.7 2-3/16	60.5 2-25/64	65.1 2.5630	25.4 1.000	M16 5/8	UC213 UC213-40 UC213-41	FC213	5.30 5.39 5.30
UCFC214 214-42 214-43 214-44	70 2-5/8 2-11/16 2-3/4	215 8-15/32	177 6-31/32	125.1 4-59/64	17 43/64	19 3/4	14 35/64	18 23/32	40 1-37/64	150 5.9055	61.4 2-13/32	67.5 2-21/32	74.6 2.9370	30.2 1.189	M16 5/8	UC214 UC214-42 UC214-43 UC214-44	FC214	6.46 6.67 6.57 6.47
UCFC215 215-45 215-46 215-47 215-48	75 2-13/16 2-7/8 2-15/16 3	220 8-21/32	184 7-1/4	130.1 5-1/8	18 23/32	19 3/4	16 5/8	18 23/32	40 1-37/64	160 6.2992	62.5 2-15/32	67.5 2-21/32	77.8 3.0630	33.3 1.311	M16 5/8	UC215 UC215-45 UC215-46 UC215-47 UC215-48	FC215	6.86 6.86 7.11 7.00 6.80
UCFC216 216-49 216-50 216-51	80 3-1/16 3-1/8 3-3/16	240 9-29/64	200 7-7/8	141.4 5-9/16	18 23/32	23 29/32	16 5/8	18 23/32	42 1-21/32	170 6.6929	67.3 2-21/32	72.5 2-55/64	82.6 3.2520	33.3 1.311	M20 3/4	UC216 UC216-49 UC216-50 UC216-51	FC216	8.47 8.65 8.52 8.39
UCFC217 217-52 217-53 217-55	85 3-1/4 3-5/16 3-7/16	250 9-27/32	208 8-3/16	147.1 5-51/64	18 23/32	23 29/32	18 23/32	20 25/32	45 1-25/32	180 7.0866	69.6 2-3/4	74.6 2-15/16	85.7 3.3740	34.1 1.343	M20 3/4	UC217 UC217-52 UC217-53 UC217-55	FC217	10.18 10.30 10.26 9.97
UCFC218 218-56	90 3-1/2	265 10-7/16	220 8-21/32	155.5 6-1/8	22 55/64	23 29/32	18 23/32	20 25/32	50 1-31/32	190 7.4803	78.3 3-3/32	83.5 3-9/32	96.0 3.7795	39.7 1.5630	M20 3/4	UC218 UC218-56	FC218	12.24 12.35