

**Flange Units (Square)**

**UCF3 (Heavy-duty)**

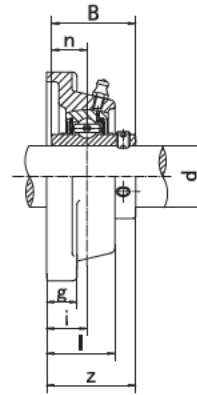
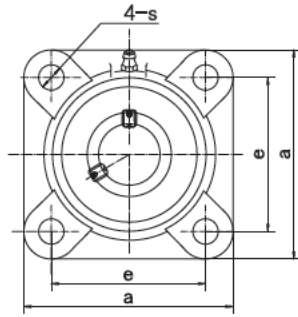

Unit NO.	Dimensions ( mm / in. )										Bolt Size mm/in.	Bearing No.	Housing No.	Weight (kg)
	d	a	e	i	g	l	s	z	B	n				
<b>UCF305</b> 305-13 305-14 305-15 305-16	25 13/16 7/8 15/16 1	110	80	16	13	29	16	39	38	15	M14	UC305 UC305-13 UC305-14 UC305-15 UC305-16	F305	1.10
<b>UCF306</b> 306-17 306-18 306-19	30 1-1/16 1-1/8 1-3/16	125	95	18	15	32	16	44	43	17	M14	UC306 UC306-17 UC306-18 UC306-19	F306	1.50
<b>UCF307</b> 307-20 307-21 307-22 307-23	35 1-1/4 1-5/16 1-3/8 1-7/16	135	100	20	16	36	19	49	48	19	M16	UC307 UC307-20 UC307-21 UC307-22 UC307-23	F307	2.00
<b>UCF308</b> 308-24 308-25	40 1-1/2 1-9/16	150	112	23	17	40	19	56	52	19	M16	UC308 UC308-24 UC308-25	F308	2.60
<b>UCF309</b> 309-26 309-27 309-28	45 1-5/8 1-11/16 1-3/4	160	125	25	18	44	19	60	57	22	M16	UC309 UC309-26 UC309-27 UC309-28	F309	3.40
<b>UCF310</b> 310-29 310-30 310-31	50 1-13/16 1-7/8 1-15/16	175	132	28	19	48	23	67	61	22	M20	UC310 UC310-29 UC310-30 UC310-31	F310	4.50
<b>UCF311</b> 311-32 311-33 311-34 311-35	55 2 2-1/16 2-1/8 2-3/16	185	140	30	20	52	23	71	66	25.0	M20	UC311 UC311-32 UC311-33 UC311-34 UC311-35	F311	5.50
<b>UCF312</b> 312-36 312-37 312-38 312-39	60 2-1/4 2-5/16 2-3/8 2-7/16	195	150	33	22	56	23	78	71	26.0	M20	UC312 UC312-36 UC312-37 UC312-38 UC312-39	F312	6.50
<b>UCF313</b> 313-40 313-41	65 2-1/2 2-9/16	208	166	33	22	58	23	78	75	30	M20	UC313 UC313-40 UC313-41	F313	7.90
<b>UCF314</b> 314-42 314-43 314-44	70 2-5/8 2-11/16 2-3/4	226	178	36	25	61	25	81	78	33	M22	UC314 UC314-42 UC314-43 UC314-44	F314	9.60
<b>UCF315</b> 315-45 315-46 315-47 315-48	75 2-13/16 2-7/8 2-15/16 3	236	184	39	25	66	25	89	82	32.0	M22	UC315 UC315-45 UC315-46 UC315-47 UC315-48	F315	11.00
<b>UCF316</b> 316-49 316-50 316-51	80 3-1/16 3-1/8 3-3/16	250	196	38	27	68	31	90	86	34	M27	UC316 UC316-49 UC316-50 UC316-51	F316	13.30
<b>UCF317</b> 317-52 317-53 317-54	85 3-1/4 3-5/16 3-7/16	260	204	44	27	74	31	100	96	40	M27	UC317 UC317-52 UC317-53 UC317-54	F317	15.30
<b>UCF318</b> 318-55 318-56	90 3-7/16 3-1/2	280	216	44	30	76	35	100	96	40	M30	UC318 UC318-55 UC318-56	F318	18.60
<b>UCF319</b> 319-58 319-59 319-60	95 3-5/8 3-11/16 3-3/4	290	228	59	30	94	35	121	103	41	M30	UC319 UC319-58 UC319-59 UC319-60	F319	22.80
<b>UCF320</b> 320-64	100 4	310	242	59	32	94	38	125	108	42	M33	UC320 UC320-64	F320	26.10
<b>UCF322</b>	110	340	266	60	35	96	41	131	117	46	M36	UC322	F322	34.90
<b>UCF324</b>	120	370	290	65	40	110	41	140	126	51	M36	UC324	F324	46.80
<b>UCF326</b>	130	410	320	65	45	115	41	146	135	54	M36	UC326	F326	62.60
<b>UCF328</b>	140	450	350	75	55	125	41	161	145	59	M36	UC328	F328	85.50