

SALF2
(SA2-Fitted)

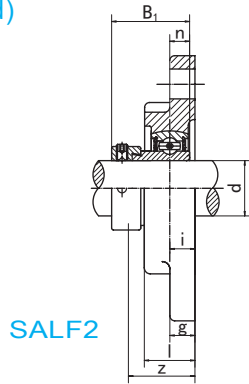

SALF2

Flange Unit
(Light duty)

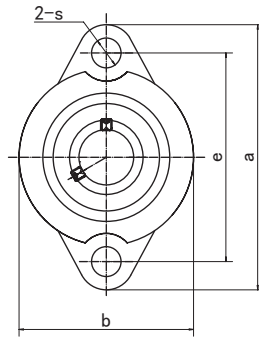

SBLF2
(SB2-Fitted)

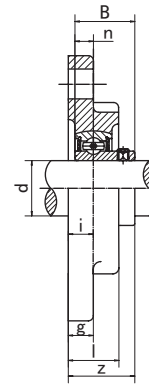

SBLF2

Unit NO.	Dimensions (mm / in.)											Bolt Size mm/in.	Bearing No.	Housing No.	Weight (kg)
	d	a	e	b	i	s	g	l	z	B ₁	n				
SALF 201 201-8	12 1/2	81 3-3/16	63.5 2-1/2	56 2-13/64	9.5 3/8	8 5/16	9.5 3/8	18 45/64	31.6 1-1/4	28.6 1 1/260	6.5 0 2559	M6	SA201 SA201-8	LF201	0.27
SALF 202 202-9 202-10	15 9/16 5/8											M8	SA202 SA202-9 SA202-10	LF202	
SALF 203 203-11	17 11/16											M10	SA203 SA203-11	LF203	
SALF 204 204-12	20 3/4	90 3-35/64	71.5 2-13/16	61 2-13/32	11 7/16	10 25/64	11 7/16	20 25/32	34.5 1-23/64	31 1 2204	7.5 0 2953	M8 5/16	SA204 SA204-12	LF204	0.35
SALF 205 205-13 205-14 205-15 205-16	25 13/16 7/8 15/16 1	95 3-3/4	76 2-63/64	64 2-33/64	11 7/16	10 25/64	11 7/16	20 25/32	34.5 1-23/64	31 1 2204	7.5 0 2953	M8 5/16	SA205 SA205-13 SA205-14 SA205-15 SA205-16	LF205	0.40
SALF 206 206-17 206-18 206-19 206-20	30 1-1/16 1-1/8 1-3/16 1-1/4	113 4-7/16	90.5 3-9/16	76 2-63/64	12 15/32	12 15/32	12 15/32	22.5 57/64	38.7 1-33/64	35.7 1 4055	9 0 3543	M10 3/8	SA206 SA206-17 SA206-18 SA206-19 SA206-20	LF206	0.60
SALF 207 207-20 207-21 207-22 207-23	35 1-1/4 1-5/16 1/3/8 1-7/16	122 4-13/16	100 3-15/16	89 3-1/2	13 33/64	12 15/32	13 33/64	24 61/64	42.4 1-43/64	38.9 1 5315	9.5 0 3740	M10 3/8	SA207 SA207-20 SA207-21 SA207-22 SA207-23	LF207	0.90

Unit NO.	Dimensions (mm / in.)											Bolt Size mm/in.	Bearing No.	Housing No.	Weight (kg)
	d	a	e	b	i	s	g	l	z	B	n				
SBLF 201 201-8	12 1/2	81 3-3/16	63.5 2-1/2	56 2-13/64	9.5 3/8	8 5/16	9.5 3/8	18 45/64	25.5 1	22 0 8661	6 0 2362	M6	SB201 SB201-8	LF201	0.24
SBLF 202 202-9 202-10	15 9/16 5/8											M8	SB202 SB202-9 SB202-10	LF202	
SBLF 203 203-11	17 11/16											M10	SB203 SB203-11	LF203	
SBLF 204 204-12	20 3/4	90 3-35/64	71.5 2-13/16	61 2-13/32	11 7/16	10 25/64	11 7/16	20 25/32	29 1-9/64	25 0 9843	7 0 2756	M8 5/16	SB204 SB204-12	LF204	0.32
SBLF 205 205-13 205-14 205-15 205-16	25 13/16 7/8 15/16 1	95 3-3/4	76 2-63/64	64 2-33/64	11 7/16	10 25/64	11 7/16	20 25/32	30.5 1-13/64	27 1 0630	7.5 0 2953	M8 5/16	SB205 SB205-13 SB205-14 SB205-15 SB205-16	LF205	0.34
SBLF 206 206-17 206-18 206-19 206-20	30 1-1/16 1-1/8 1-3/16 1-1/4	113 4-7/16	90.5 3-9/16	76 2-63/64	12 15/32	12 15/32	12 15/32	22.5 57/64	34 1-11/32	30 1 1811	8 0 3150	M10 3/8	SB206 SB206-17 SB206-18 SB206-19 SB206-20	LF206	0.53
SBLF 207 207-20 207-21 207-22 207-23	35 1-1/4 1-5/16 1/3/8 1-7/16	122 4-13/16	100 3-15/16	89 3-1/2	13 33/64	12 15/32	13 33/64	24 61/64	36.5 1-7/16	32 1 2598	8.5 0 3364	M10 3/8	SB207 SB207-20 SB207-21 SB207-22 SB207-23	LF207	0.73

Note: To specify relubricatable units, add "G" suffix, (e.g., SBLF205-16G)